

## ALPROLIX™ Reconstitution with Pre-Filled Syringe

### \*\*\* IMPORTANT \*\*\*

Aseptic techniques must be used at all times.  
Use the diluent in the pre-filled syringe supplied in the package.

#### A. Setting Up

Remove the plastic cap from the ALPROLIX vial and wipe the rubber stopper of the vial with an alcohol wipe. Allow the rubber stopper to dry. After cleaning, do not touch the rubber stopper with your hand or allow it to touch any surface.

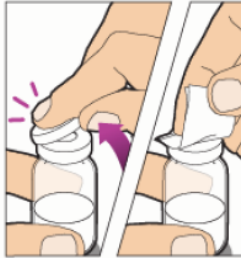

Completely remove the backing from the vial adapter package by peeling back the lid. Do not remove the vial adapter from the package or touch the inside of the package of the adapter.



Keep the vial on a flat surface. Hold the vial adapter package with one hand and using the other hand, place the vial adapter over the vial. Place the adapter spike directly above the centre of the rubber stopper. Push the vial adapter straight down until the adapter spike punctures the centre of the vial stopper and is fully inserted.

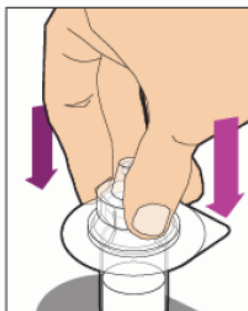

Lift the package cover away from the vial adapter and discard the cover.

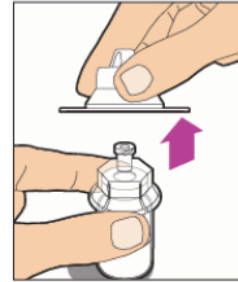

Take the plunger rod and syringe out of the package. Hold the plunger rod at the circular disk. Place the tip of the plunger rod into the end of the syringe. Turn clockwise until it is securely attached. Only use the diluent syringe provided in the ALPROLIX package.

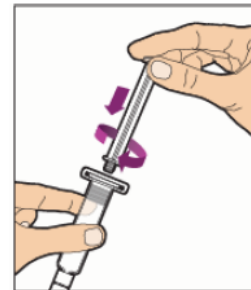

#### B. Reconstituting the injection

With one hand, hold the diluent syringe by the ridged part right under the cap, with the cap pointing up. Do not use if the cap has been removed or is not securely attached.

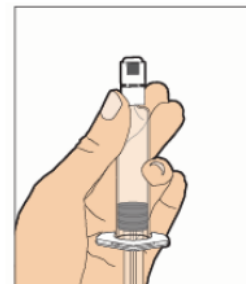

With your other hand, grasp the cap and bend it at a 90° angle until it snaps off. After the cap snaps off, you will see the glass tip of the syringe. Do not touch the glass tip of the syringe or inside of the cap.



Be sure the vial is sitting on a flat surface. Insert the tip of the syringe into the adapter opening. Turn the syringe clockwise until it is securely attached to the adapter.

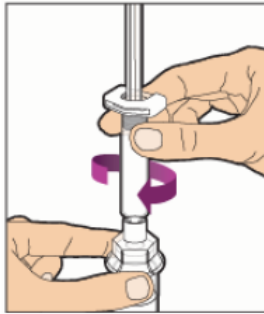

Slowly depress the plunger rod to inject all of the diluent into the vial. The plunger rod may rise slightly after this process. This is normal.

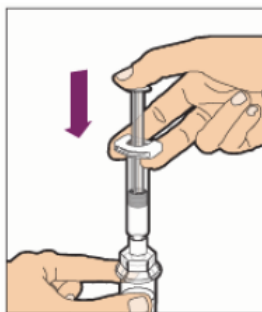

With the syringe still connected to the adapter, gently swirl the vial until the product is completely dissolved. The final solution should be clear to slightly opalescent and colourless. Do not shake. Do not use the reconstituted ALPROLIX if it contains visible particles or is cloudy.

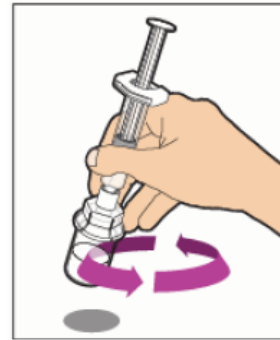

Make sure the plunger rod is completely depressed. Turn the vial upside-down. Slowly pull on the plunger rod to draw the solution into the syringe. Be careful not to pull the plunger rod completely out of the syringe.

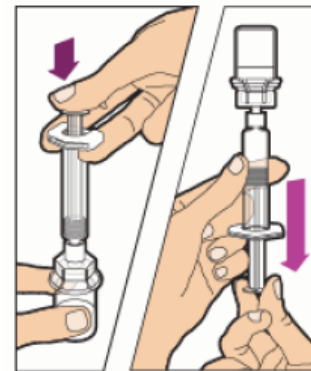

Gently unscrew the syringe from the vial adapter and dispose of the vial with the adapter still attached. Do not touch the syringe tip or the inside of the cap.

Your ALPROLIX is now ready to be connected to your infusion tubing set. Use the reconstituted ALPROLIX as soon as possible, but no later than 3 hours after reconstitution. Protect from direct sunlight. **Do not refrigerate after reconstitution.**

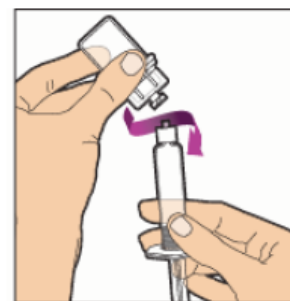

### C. Pooling

If you are using two or more vials of ALPROLIX, you can follow these pooling steps. Be sure to leave the vial adapter attached to the vial, as you will need it for attaching a large luer lock syringe. Do not detach the diluent syringe or the large luer lock syringe until you are ready to attach the large luer lock syringe to the next vial (with vial adapter attached).

Remove the diluent syringe from the vial adapter by turning it counterclockwise until it is completely detached.

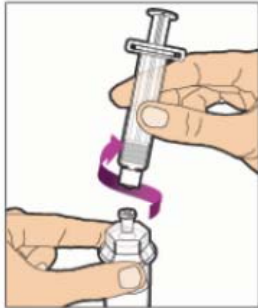

Attach a separate large luer lock syringe by turning clockwise until it is securely attached.

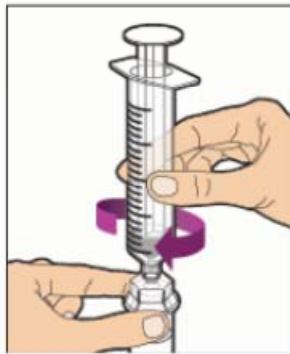

Slowly pull on the plunger rod to draw the solution into the syringe. Repeat this pooling procedure with each vial you will be using. Once you have pooled the required dose, proceed to administration using the large luer lock syringe.

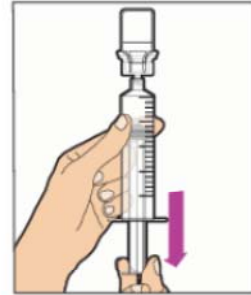

**NOTE:** The pre-filled glass syringe with diluent used to reconstitute and administer product **may not be compatible with all needleless connectors for intravenous catheters** (e.g. ICU Medical MicroClave® Neutral Connector). You may need to withdraw reconstituted product with a sterile plastic syringe with a standard luer-lock connector.

#### COMMENTS:

Date Effective: 25 Feb 2016

Revised Date: N/A

Version: 1.0

Approved By: TM Network

Document Number:PTMGNR00015

References:Biogen Idec Canada Inc. Alprolix™ Product Monograph, [www.biogen.ca](http://www.biogen.ca)

*For questions or comments about this document, please contact Transfusion.SafetyTeam@albertahealthservices.ca*